

VALVES, FITTINGS, ACCESSORIES

FITTINGS

► SERIES GV - STRAIGHT FITTINGS - BARB-STYLE CONNECTION

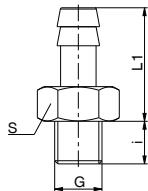

- For assembling with hose clips
- Straight version

Order no.	► Technical data				
	GVM3	GV1-8X5ID	GV1-8X6ID	GV1-8X8ID	GV1-4X8ID
Fixing thread	M3	G1/8"	G1/8"	G1/8"	G1/4"
Inside-Ø for hose [mm]	3	5	6	8	8
Length [mm]	9.9	30.0	30.0	30.0	32.5
Dimension i [mm]	2.7	6	6	6	8
Dimension L1 [mm]	7.2	24	24	24	24.5
S [mm]	4.5	13	13	13	17

Order no.	► Technical data			
	GV1-4X10ID	GV3-8X13ID	GV1-2X13ID	GV1-2X16ID
Fixing thread	G1/4"	G3/8"	G1/2"	G1/2"
Inside-Ø for hose [mm]	10	13	13	16
Length [mm]	32.5	33.5	35.0	39.5
Dimension i [mm]	8	9	10	10
Dimension L1 [mm]	24.5	24.5	25	29.5
S [mm]	17	19	24	24

► SERIES GV - STRAIGHT FITTINGS - QUICK CONNECT STYLE

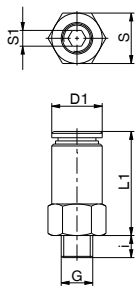

- Cost reduction through quick assembly and disassembly
- Straight version

Order no.	► Technical data					
	GVM5	GV1-8X4	GV1-8X6	GV1-8X8	GV1-4X6	GV1-4X8
Fixing thread	M5	G1/8"	G1/8"	G1/8"	G1/4"	G1/4"
Outside-Ø for hose [mm]	4	4	6	8	6	8
Length [mm]	20.0	19.0	20.0	25.0	21.5	23.0
Dimension i [mm]	3.5	3.5	5	5	7	7
Dimension L1 [mm]	16.5	16.5	14	20	14.5	16
Dimension D1 [mm]	8	8	10	14	12	14
S1 [mm]	2.5	2.5	3	5	4	6
S [mm]	8	8	13	14	17	17



► SERIES WV - ANGLED FITTING, BARB STYLE CONNECTION

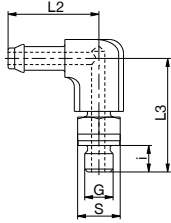

- For assembling with hose clips
- Angled version

► Technical data

Order no.

WVM3

Fixing thread	M3
Inside-Ø for hose [mm]	3
Dimension i [mm]	2.7
Dimension L2 [mm]	13.3
Dimension L3 [mm]	11.4
S [mm]	4.5

► WV SERIES - ANGLED FITTINGS- QUICK CONNECT STYLE

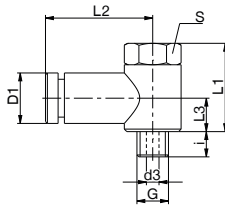

- Cost reduction through quick assembly and disassembly
- Angled and swivel-mounted

► Technical data

Order no.

WVM5 WVM7 WV1-8X4 WV1-8X6 WV1-8X8 WV1-4X6

Fixing thread	M5		G1/8"	G1/8"	G1/8"	G1/4"
Outside-Ø for hose [mm]	4		4	6	8	6
Dimension i [mm]	4		6.5	6.5	6.5	8
Dimension L1 [mm]	14		20	20	20	21
Dimension L2 [mm]	17		20.5	21.5	23.5	23.5
Dimension L3 [mm]	5.3		8	8	8	8
Dimension d3 [mm]	2		5	5	5	7
Dimension D1 [mm]	8		10	12	14	12
S [mm]	8		14	14	14	17

