

INDUSTRIAL SHOCK ABSORBERS POWERSTOP

THREAD M6X0.5

▶ SERIES



MINI ENERGY



The slender

- ▶ **Material** Stainless steel ▶ **Organic oil (biodegradable)** HEES
- ▶ **Permitted temperature range** -10 ... +70 [°C] - **H1-certified** Yes
- ▶ **Angle of Impact max.** 2 [°] - **PWIS-free** Yes
- ▶ **Max. force at fixed stop** 0.5 [kN] ▶ **RoHS compliant** - **REACH compliant** Yes
- ▶ **Lock nut tightening torque**
 - **Mini Energy** 2 [Nm] - **Mini Energy** 10 [bar]

▶ TECHNICAL DATA

Design	Series	Thread	Stroke variant	Stroke max. [mm]	Hardness degree	Impact velocity		Energy absorption max.			Protection	Reset			Head	Integrated Fix stop	Version												
						min.	max.	Continuous operation per stroke	Emergency stop operation per hour	per stroke		Force		Time															
												[m/s]	[m/s]					[J]	[J/h]	[J]	min. [N]	max. [N]	max. [s]						
MINI ENERGY	P	ME	06X05	N	5	H	0,1	1,2	1,8	5.000	1,8	D	1,5	2,5	0,15	D	x	-A											
						-																							
						M	0,8	2,2	1,8	5.000	1,8								-										
					S	1,8	3,5	1,8	5.000	1,8	A	1,5	2,5	0,15	K	x													

PROTECTION

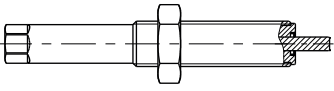
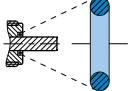
no protection	Wiper (NBR)
D -A	A -A
	
in a clean environment	against liquid, oil, ...

TECHNICAL DRAWINGS

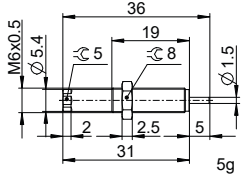
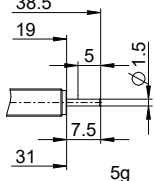
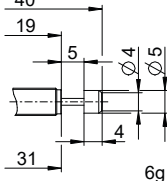
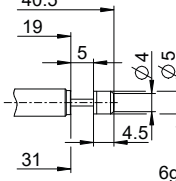
	Short piston rod no head	Long piston rod no head	with steel head	with plastic head
	N D -A	N E -A	N S -A	N K -A
MINI ENERGY				



INDUSTRIAL SHOCK ABSORBERS POWERSTOP

THREAD M6X0.5

▶ ACCESSORIES

Pos.	Order no.	Accessories	Remarks
①	PAH06X05-A	Stop sleeve	Including 1x PVM06X05-A. Industrial shock absorber with bellow excluded.
②	PVM06X05-A	Stainless steel locknut	Included with the industrial shock absorber.
③	PDD06X05-A	Pressure chamber seal	Recommended fixation with PVM06X05-A. Seal must be in full contact on both sides.

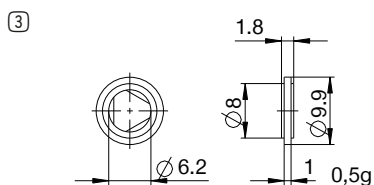
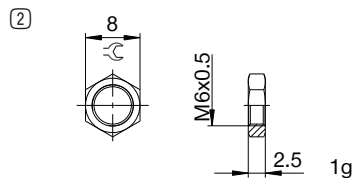
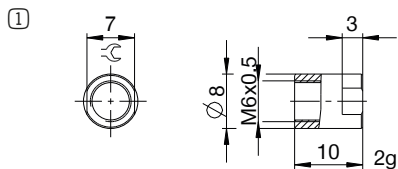

▶ CLASSIFICATION

P **ME** **06X05** **N** **S** **D** **S** **-A**

Design

P Industrial shock absorbers PowerStop

Series

ME Mini Energy

SE Standard Energy

HE High Energy

AE Adjustable Energy

Thread

06 Thread nominal diameter

X

05 Thread pitch (factor 10)

Stroke variant

N Standard stroke

L Long stroke

Hardness degree

H Hard (0.1 - 1.2 m/s; Adjustable Energy: 0.1 - 5 m/s)

M Medium (0.8 - 2.2 m/s)

S Soft (1.8 - 3.5 m/s)

W Supersoft (3 - 5 m/s)

Protection

D no protection

F Felt ring

A Wiper (NBR)

B Bellow (TPE)

Head

D Short piston rod no head

E Long piston rod no head

S with steel head

K with plastic head

Version

-A Versioning from a to z