

# ENERGY ELEMENT

## WER3000FPN01-00

Order no.	► Technical Data
Series	WER3000
Transmission mode	Communication
Data transmission	Profinet/Industrial Ethernet
Compatible with installation size	WWR100-B / WWR125-B / WWR160-B / WWR1160 / WWR1200
Compatible with	Fixed part
No. of contacts	4
Connection type	Plug-in Connector
Connection category	CAT5
Data rate [Mbit/s]	100
Fixing thread	M12
Coding	D
Connection type	Socket
Connection type	Round plug
Connection alignment	radial or axial
Joining force [N]	40
Release force [N]	40
Approvals	LABS / REACH / RoHS
Protection to IEC 60529	IP54 *
Weight [kg]	0.11

\*only in coupled state

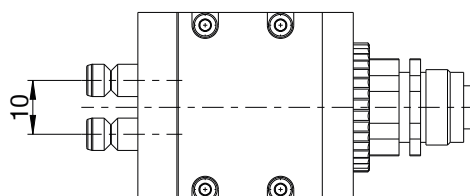
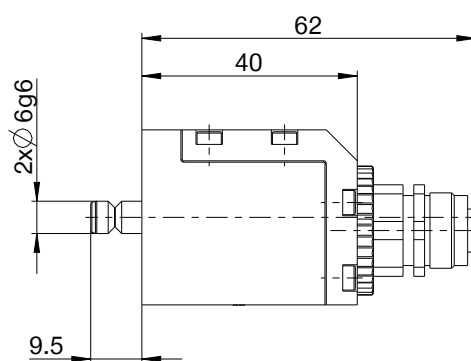
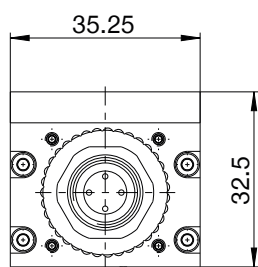
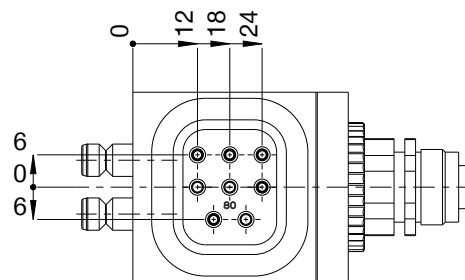

PIN assignment

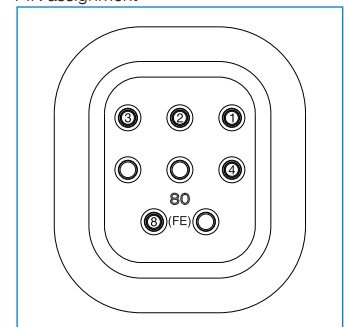

PIN assignment

